

## UPPER FLOOR

648 SQ. FT.

8' CEILING HEIGHT

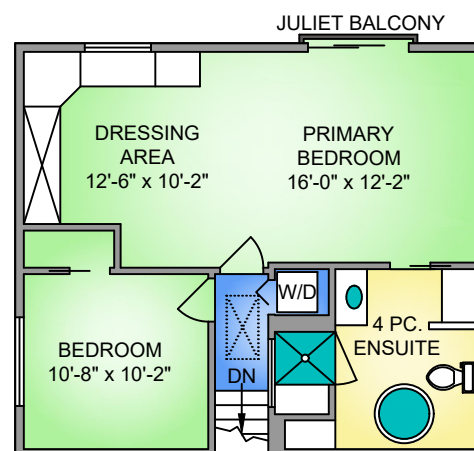

## LOWER FLOOR

641 SQ. FT.

7'-8" CEILING HEIGHT

## MAIN FLOOR

658 SQ. FT.

8' CEILING HEIGHT

NORTH

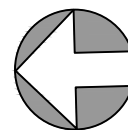
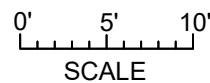

1657 YALE STREET

MARCH 26, 2021

PREPARED FOR THE EXCLUSIVE USE OF LISA WILLIAMS  
PLANS MAY NOT BE 100% ACCURATE, IF CRITICAL BUYER TO VERIFY.

| FLOOR  | AREA (SQ. FT.) |        |              |
|--------|----------------|--------|--------------|
|        | FINISHED       | GARAGE | DECK / PATIO |
| MAIN   | 658            | 262    | -            |
| UPPER  | 648            | -      | -            |
| LOWER  | 641            | -      | 260          |
| STUDIO | 201            | -      | -            |
| TOTAL  | 2148           | 262    | 260          |

**PROPERMEASURE**  
PRECISION

250-884-9753  
matt@propermeasure.com  
www.propermeasure.com

*Lisa Williams*

Sotheby's  
INTERNATIONAL REALTY

Canada