

MAIN FLOOR
1080 SQ. FT.
9' CEILING HEIGHT

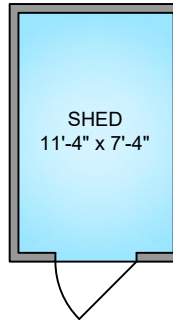

UPPER FLOOR
1377 SQ. FT.
8' CEILING HEIGHT

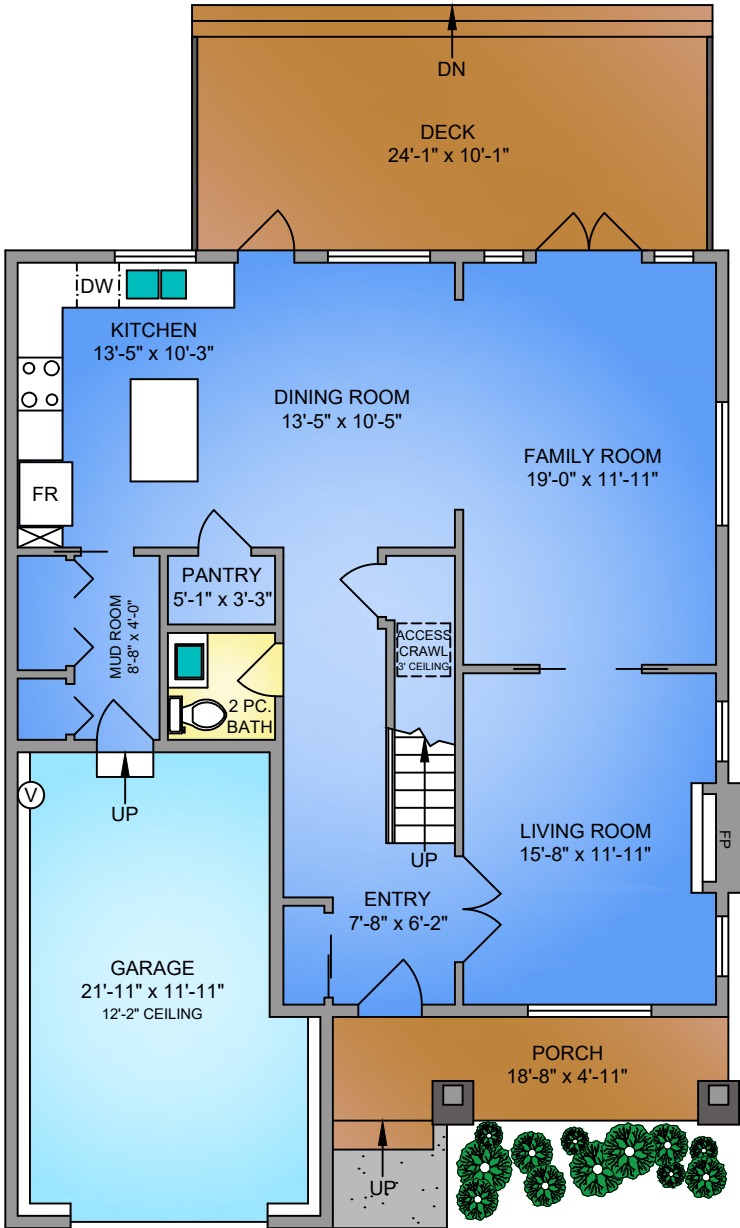
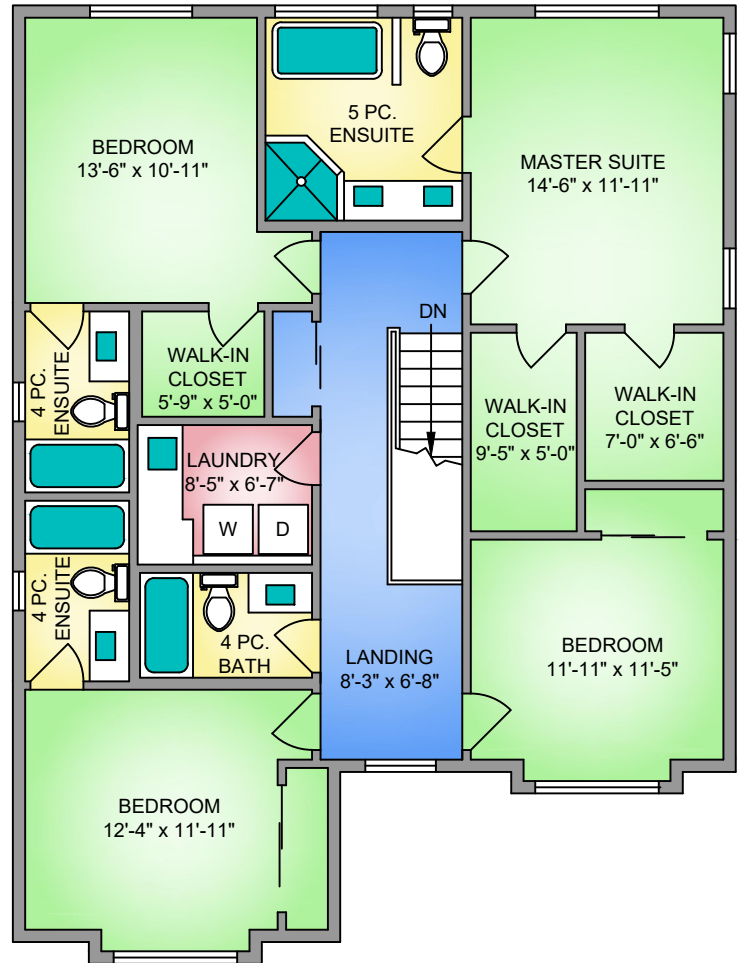

NORTH

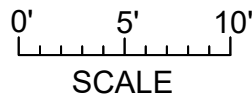
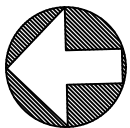

1609 AMPHION STREET SEPTEMBER 10, 2018 PREPARED FOR THE EXCLUSIVE USE OF LISA WILLIAMS PLANS MAY NOT BE 100% ACCURATE, IF CRITICAL BUYER TO VERIFY.			
FLOOR	AREA (SQ. FT.)		
	FINISHED	GARAGE	DECK / PORCH
MAIN	1080	310	328
UPPER	1377	-	-
TOTAL	2457	310	328