

UPPER FLOOR 1912 SQ. FT.

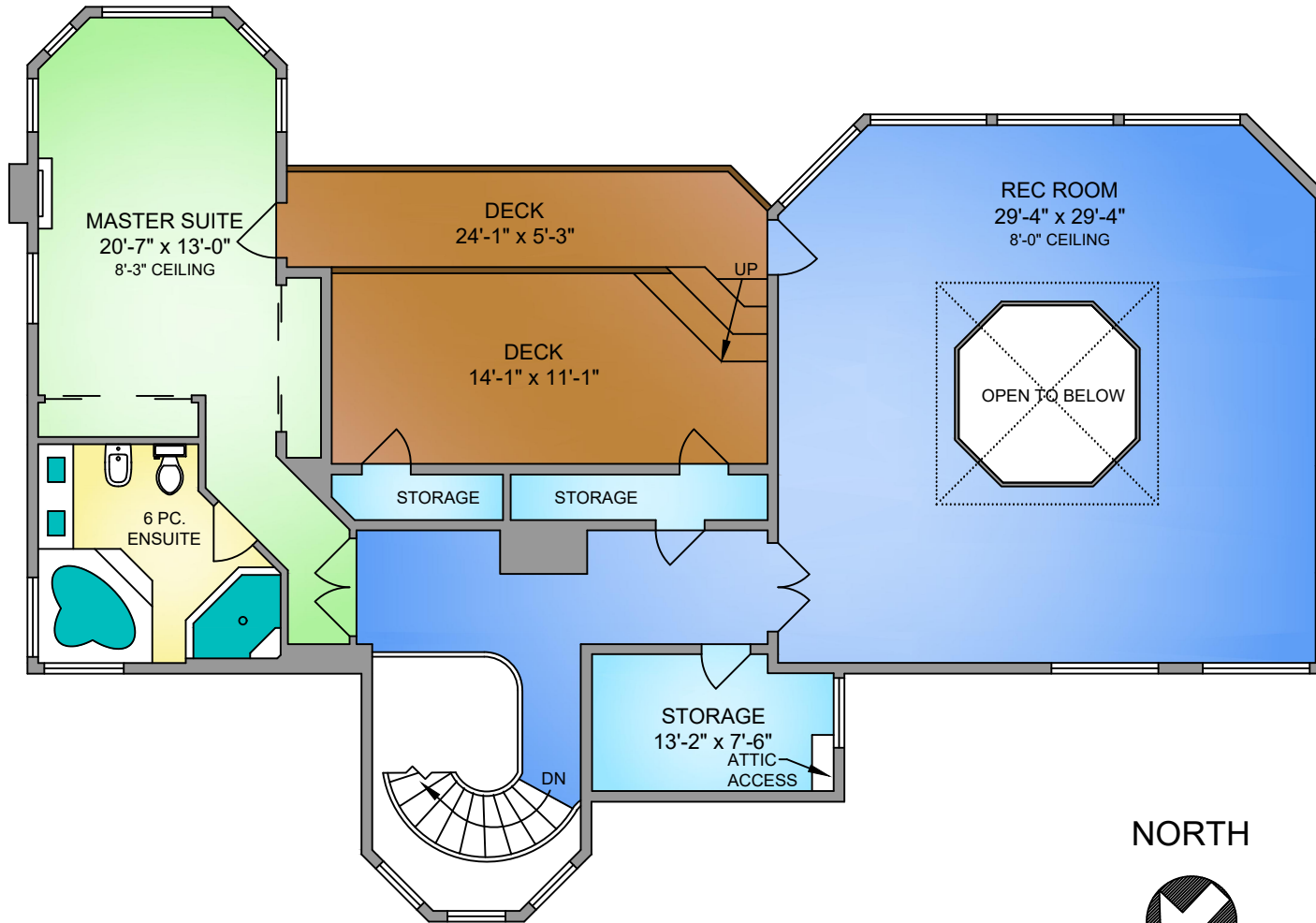

NORTH

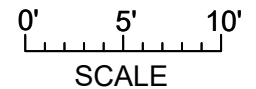

2547 TRYON ROAD SEPTEMBER 26, 2017 PREPARED FOR THE EXCLUSIVE USE OF CHACE WHITSON PLANS MAY NOT BE 100% ACCURATE, IF CRITICAL BUYER TO VERIFY.			
FLOOR	AREA (SQ. FT.)		
	FINISHED	GARAGE	DECK / PATIO
MAIN	3821	-	2860
UPPER	1912	-	380
TOTAL	5733	-	3240
GARAGE / SUITE	580	300	-



CHACE WHITSON

• PERSONAL REAL ESTATE CORPORATION •



250-884-9753
matt@propermeasure.com
www.propermeasure.com